

ゴーストデモ

GHOST DEMO

西 太志

Taishi Nishi

## SHISEIDO GALLERY

14th shiseido art egg Taishi Nishi Exhibition

Duration: October 2 (Fri) – 25 (Sun), 2020

Weekdays: 11:00 – 19:00    Sundays and holidays: 11:00 – 18:00

Closed Mondays (including national holidays falling on Monday)

Reservation required

Organized by Shiseido Company, Limited

Shiseido Gallery has been engaging in a range of activities for almost a century, based on the notion of discovering and creating new aesthetics. Shiseido art egg is an open call program designed to give to promising new artists access to the Gallery. This year’s shiseido art egg, the fourteenth, will feature solo exhibitions by three artists, selected from among 215 applications nationwide.

First of the trio of artists to be featured, Taishi Nishi produces paintings and sculptural works on themes including anonymity, and the boundaries of reality and fiction.

Taking as his starting point unreal sensations and feelings of incongruity acquired from the text and imagery disseminated on the internet amid today’s easy access to information on events around the world, he converts these to works that weave in his personal experiences and memories. This art practice that endeavors to reconstruct information could be described as an act of exploring what reality means for him.

In Nishi’s paintings, which the artist says are influenced by Goya’s “Black Paintings,” movie-like scenes are rendered in dark tones using charcoals and paint, evoking places resembling nothing in the real world. Like his paintings with their rough brushmarks, his black ceramic objects, and sculptures made by soaking clothing in pottery clay and firing it, capture traces of their maker. In recent years Nishi has begun to exhibit paintings and sculpture in combination, exploring the mutual connection between imagery and materiality.

This exhibition will feature paintings, including some new works, as well as an installation consisting of sculptural pieces.

### Taishi Nishi

1983: Born in Osaka Prefecture

2006: Graduated from the Oil Painting Course, Fine Arts Department, Osaka University of Arts

2015: Completed the Painting Course, Department of Painting, Graduate School of Arts (Master’s Course), Kyoto City University of Arts

Currently lives in Shizuoka

### Main exhibitions

2020: Solo exhibition “Look at the other side of the moon” at FINCH ARTS, Kyoto

2019: “Nana Funo + Taishi Nishi -An incident touched the bottom-” at 2kw Gallery, Shiga

2018: Solo exhibition “NIGHT SEA JOURNEY” at GALLERY ZERO, Osaka

2017–18: “Taishi Nishi + Yosuke Yano -Thorn of Comfort-“ at 8/ ART GALLERY/ Tomio Koyama Gallery, Tokyo

2017: “KCUA Transmit Program 2017 at Kyoto City University of Arts Art Gallery @KCUA, Kyoto

2016: Participated in “Shell Art Award 2016” at The National Art Center, Tokyo

2015: Participated in “Art Award Tokyo Marunouchi 2015,” at Marunouchi Building Marucube, Tokyo

Whether tragic event or joyful scene, information from images and text flows like snapshots from a novel or film, as if imaginary. These days, with the news in the world at our fingertips, it all takes on a ghostly quality.

Receiving such information, and adding my own experiences and memories, I undertake a reconstruction of sorts, redrawing it all into something real to me.

Each element may only constitute a tiny progression, but as their numbers grow they control the space, and acquire flesh as something more real.

Taishi Nishi

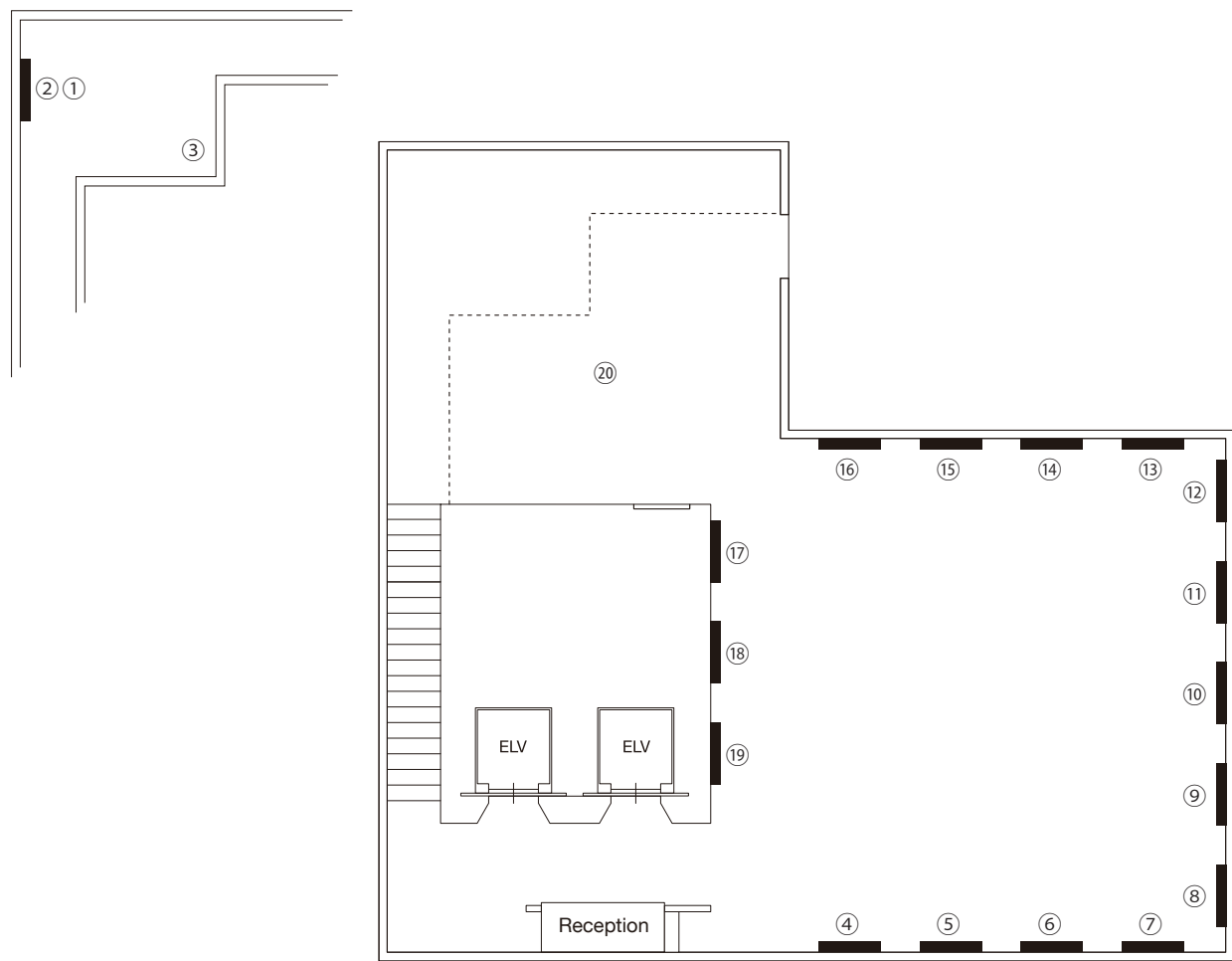

① *Lucid Dream Guide* 2018    China clay, porcelain earth, hemp cloth, wool, pigment

② *Drops of Light Floating on the Sea* 2018    Water-based alkyd resin, oil paint, charcoal, and pigment on canvas

③ *Green Watchman* 2020    China clay (stand:driftwood, hemp cloth)

④ *NIGHT SEA JOURNEY* 2018    Water-based alkyd resin, oil paint, charcoal, and pigment on canvas

⑤ *Catching Smoke* 2017    Water-based alkyd resin, oil paint, acryl resin, charcoal, and pigment on canvas

⑥ *Blue Night Continued* 2017    Water-based alkyd resin, oil paint, acryl resin, charcoal, pigment on canvas

⑦ *Dripping Light* 2017    Water-based alkyd resin, oil paint, acryl resin, charcoal, and pigment on canvas

⑧ *On the Hill* 2020    Water-based alkyd resin, oil paint, and charcoal on canvas

⑨ *Journey’s End* 2020    Water-based alkyd resin, oil paint, and charcoal on canvas

⑩ *Whirlpool of Light* 2020    Water-based alkyd resin, oil paint, and charcoal on canvas

⑪ *Whereabouts of the Masks* 2020    Water-based alkyd resin, oil paint, and charcoal on canvas

⑫ *Flames in Grass/Vines* 2020    Water-based alkyd resin, oil paint, and charcoal on canvas

⑬ *Laboratory* 2017    Water-based alkyd resin, oil paint, acryl resin, charcoal, and pigment on canvas

⑭ *Typhoon Voice* 2020    Water-based alkyd resin, oil paint, and charcoal on canvas

⑮ *Dark Side of the Moon Viewing* 2020    Water-based alkyd resin, oil paint, and charcoal on canvas

⑯ *Bonfire at Night* 2017    Water-based alkyd resin, oil paint, acryl resin, charcoal, and pigment on canvas

⑰ *Conductor* 2017    Water-based alkyd resin, oil paint, acryl resin, charcoal, and pigment on canvas

⑱ *Fence* 2017    Water-based alkyd resin, oil paint, acryl resin, charcoal, and pigment on canvas

⑲ *Sleeping in the Grass* 2017    Water-based alkyd resin, oil paint, acryl resin, charcoal, and pigment on canvas

⑳ *In Every Era* 2020    China clay, porcelain earth, stepladder, timber, driftwood, cardboard, canvas, etc.